

Congratulations! You have just opened the box of the most creative piece of photography gear on earth – **The Light Blaster™**

Here is what you need to get started:

● From Us:

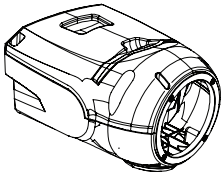

The Light Blaster

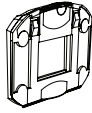

1 Slide cartridge



Slide or transparency

● From You:

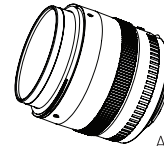

A lens

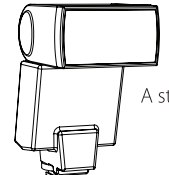

A strobe

Before we start, a quick warning. The Light Blaster is a powerful creative tool. It can be used for projecting on walls, seamless backdrops, rocks and even human beings. As such, it is capable of altering reality, use it with caution.

“With great power, comes great responsibility”

Placing a Slide or a Transparency:

1. Open the slide cartridge by pressing down the area (marked here in green).

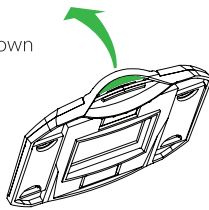

● Slides

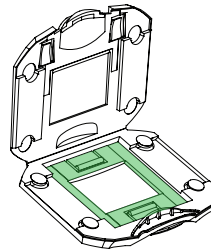

● Transparencys/
unframed film

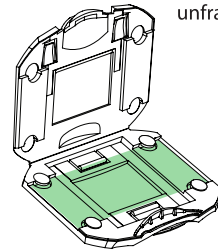

2. Place the slide/transparency/unframed film in the right socket.

3. Close the cartridge.

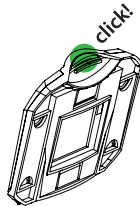
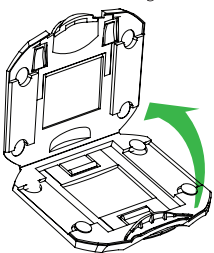

Push it into the cartridge slot...

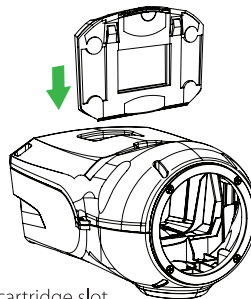

...till you hear the **click**.

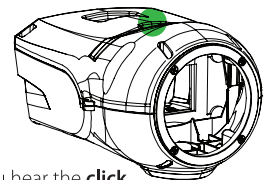

Mounting a Lens:

Use the metal bayonet on the front side of the Light Blaster to place and rotate a Canon lens. You should rotate the lens until it fits firmly. The Light Blaster is compatible with all EF and EF-S Canon lenses. The larger the max aperture is, the more light the Light Blaster will pass through.

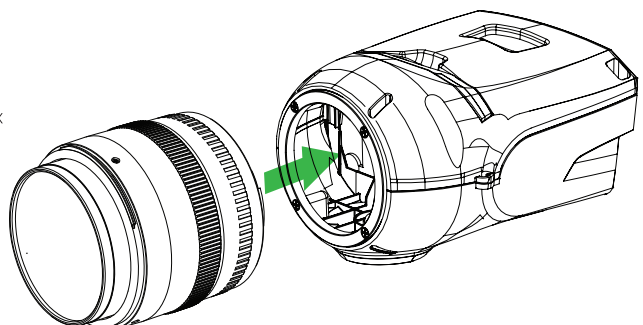

If you own a different type of lens, you can mount it to the Light Blaster with a relevant lens adapter (e.g., Nikon to Canon adapter, sold separately).

Mounting a Strobe:

- The Light Blaster is compatible with most commercial hot shoe strobes.

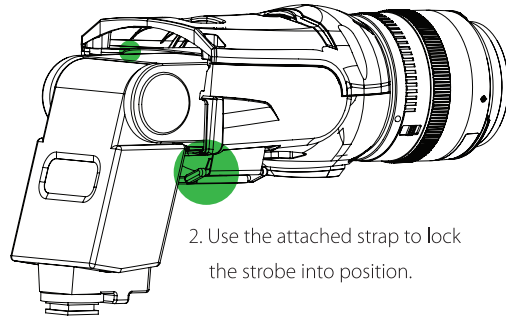
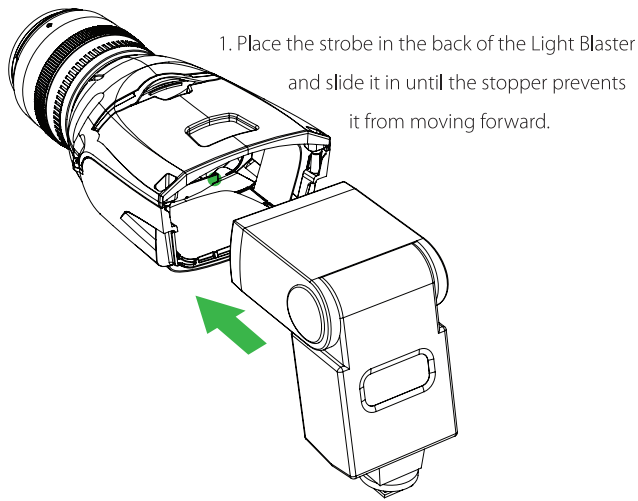

To get the strobe firing when you shoot, the strobe should be synced to the camera via a cable, a wireless trigger or a camera syncing mechanism like Nikon CLS or Canon wireless E-TTL.

Projecting Images:

- Once you have the lens, strobe and slide mounted, it is time to project slides.

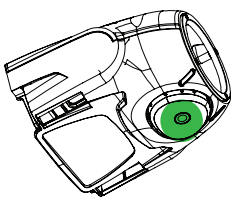
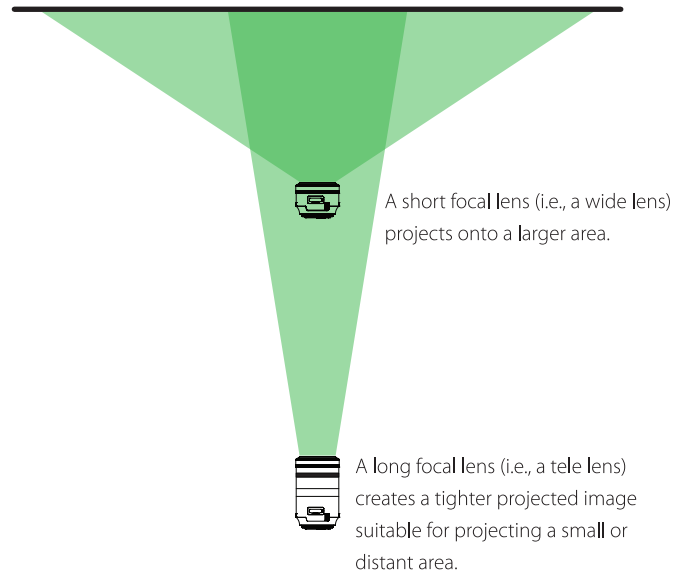
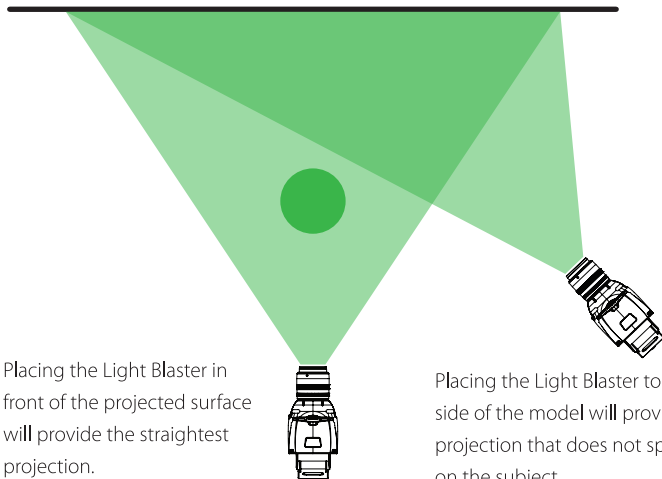

The Light Blaster can be mounted on a tripod or light stand using the tripod thread on the bottom of the unit.

Focusing: Use the attached transparencies to focus the lens; set the lens's focus so the projected patterns will be sharp. You can now use your slide or transparency.

Printing Slides:

- If you want to explore more creative options, you can use one of the Light Blaster creative kits found on www.light-blaster.com/creative-kits or print your own slides. You can use the template located at <http://light-blaster.com> to print and cut transparencies to match your creative vision.

* Our team searched the earth for interesting slides. We went high and low, across valleys, mountains and remote markets to bring you the best collection of totally random slides. Feel free to use these slides for your personal work. If people appear in the slides, you will need to obtain a model release from them before publishing the work.

* Nikon and Canon Trademarks are the property of their respected owners.

Protected by United States Patent Nos. 9,341,927 and D750,692. Other US and International patents and rights pending.